

FICHE D'HOMOLOGATION / HOMOLOGATION FORM

050-TM-05



COMMISSION
INTERNATIONALE
DE KARTING - FIA



PNEUMATIQUE / TYRE 5" SLICK MINI

Constructeur / <i>Manufacturer</i>	Reifenwerk Heidenau GmbH&Co.KG
Marque / <i>Make</i>	MOJO
Modèle / <i>Model</i>	C2 4.0/10.0-5
Catégorie / <i>Categorie</i>	Group 3
Durée de l'homologation / <i>Validity of the Homologation</i>	3 ans / 3 years
Nombre de pages / <i>Number of pages</i>	4
La présente Fiche d'Homologation reproduit descriptions, illustrations et dimensions du pneumatique au moment de l'homologation CIK-FIA.	<i>This Homologation Form reproduces descriptions, illustrations and dimensions of the tyre at the moment of the CIK-FIA homologation.</i>
	
Photo du pneu monté sur la jante / <i>Photo of the tyre fitted to the rim</i>	Dessin de la bande de roulement / <i>Tread design drawing</i>
Signature et tampon de l'ASN / <i>Signature and stamp of the ASN</i>	Signature et tampon de la CIK-FIA / <i>Signature and stamp of the CIK-FIA</i>
	

Descriptions Techniques	Technical Descriptions
Sous une température de 23°C +/-2°C, avec une humidité de 50% +/-5%	At a temperature of 23°C +/-2°C and with a humidity of 50% +/-5%

Pt	Descriptions / Descriptions	Valeurs / Value		Tolérances / Tolerances	
1	Dimensions / Dimensions	4.0/10.0-5		--	
2	Désignation du mélange / Tread compound designation	C2		--	
3	Pression de service / Service pressure	0.85 bar		+/- 0.3 bar	
4	Pression de gonflage / Inflation pressure	4.0 bar		max.	
5	Capacité de charge / Load capacity	50 kg		max.	
6	Vitesse maximale / Maximum speed	140 km/h			
7	Rigidité latérale et verticale (sous charge de 40 kg) / Lateral and vertical stiffness (under 40 kg load)	L: 1.0 mm V: 14.0 mm		L: +/-1 V: +/-2	
8					
9	Profondeur du profil / Depth of tread	3.5 mm		+/- 0.5 mm	
10	Poids en grammes / Weight in grams	910		+/- 10%	
11	Nombre de plis / Numbers of plies	2		--	
12	Épaisseur de la bande de roulement / Tread thickness	4.5 mm		+/- 1.0 mm	
13	Nombre d'indicateurs d'usure du pneu / Number of tread wear indicators	8		--	
14	Matériau de la carcasse / Carcass material	Polyester		--	
15	Angle de tissage de la toile du pneu / Angle of tyre canvas	30°		+/- 3°	
16	Type de fil de tissage (selon ISO) / Canvas thread type (according to ISO)	1100		--	
17	Pneu tubeless / Tubeless tyre	Yes		--	
18	Dureté superficielle de la bande de roulement (ISO 48:2018 – 2 échantillons de 2 mm d'épaisseur) / Superficial tread hardness (ISO 48:2018 – 2 samples of 2 mm thickness)	52.2		+/- 5 DIDC - IRHD	
19	Contrainte-déformation en traction (ISO 37:2017 – éprouvette type 3) / Tensile stress-strain (ISO 37:2017 – type 3 sample)	à / at 100%	à / at 300%	à / at 100%	à / at 300%
		1.8	7.1	+/- 0.5 MPa	+/- 0.8 MPa
20	Largeur de la bande / Tread width (ASTM F870-94 2016)	49 mm		Avant/Front: max. 80 mm	

Dessin

Drawing

Dessin du pneu en section transversale et dimensions
du pneu monté sur une jante /
Drawing of tyre cross section and dimensions of the tyre fitted to a rim

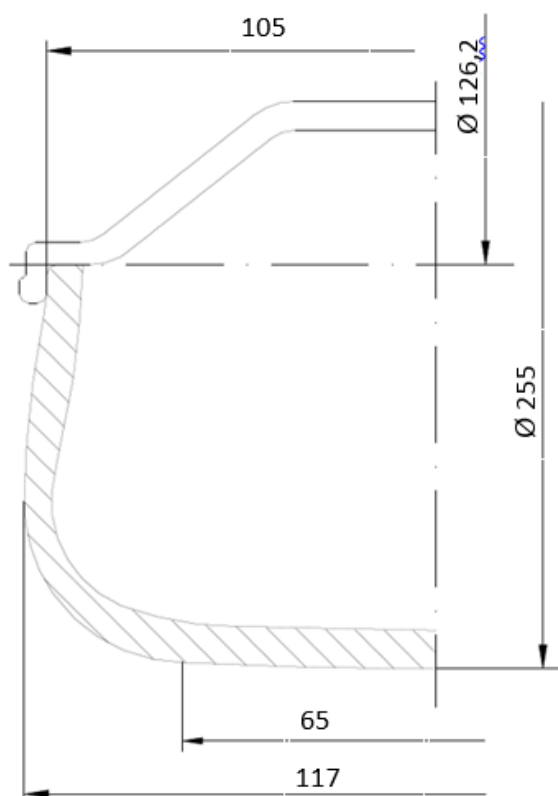
Dimensions /
DimensionsTolérances /
Tolerances

Ø 255 mm

+/- 5.0 mm

Ø 126.2 mm*

+0/-1.0 mm

117 mm

+/- 3.0 mm

65 mm

+/- 3.0 mm

105 mm

+/- 2.0

*Dimension selon Dessin Technique N° 4 jante 5" standardisée /
Dimension according to Technical Drawing N° 4 standardised 5" rim

DESSIN TECHNIQUE N°4

Jante 5"

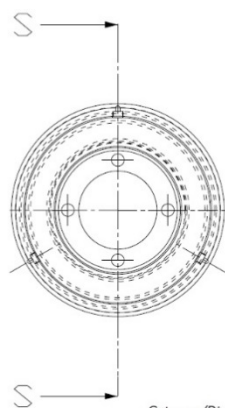

Cotes en/Dimensions in mm

TECHNICAL DRAWING No. 4

5" Rim

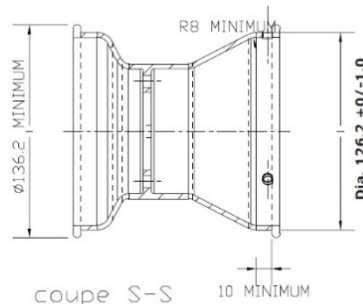

coupe S-S

Photos et Inscriptions	<i>Photos and Inscriptions</i>																																							
Seules les inscriptions qui ne changeront pas tout au long de la fabrication sont reportées ci-dessous.	<i>Only the inscriptions which will not change during production are mentioned below.</i>																																							
Photo du flanc extérieur du pneu / <i>Photo of tyre external sidewall</i>	Inscription sur le flanc extérieur du pneu / <i>Inscriptions on tyre external sidewall</i>																																							
	<table border="1"> <thead> <tr> <th data-bbox="799 613 1214 667">Texte / Text</th> <th data-bbox="1219 613 1366 667">Hauteur / Height</th> <th data-bbox="1370 613 1514 667">Trait / Stroke</th> </tr> </thead> <tbody> <tr> <td data-bbox="799 667 1214 712">MOJO (printed)</td> <td data-bbox="1219 667 1366 712">11 mm</td> <td data-bbox="1370 667 1514 712">2.5 mm</td> </tr> <tr> <td data-bbox="799 712 1214 779">  </td> <td data-bbox="1219 712 1366 779">9 mm</td> <td data-bbox="1370 712 1514 779"></td> </tr> <tr> <td data-bbox="799 779 1214 824">FOR RACING PURPOSE ONLY</td> <td data-bbox="1219 779 1366 824">4 mm</td> <td data-bbox="1370 779 1514 824">0.5 mm</td> </tr> <tr> <td data-bbox="799 824 1214 913">MAX. INFLATION PRESSURE 4.0 BAR / 58 PSI</td> <td data-bbox="1219 824 1366 913">4 mm</td> <td data-bbox="1370 824 1514 913">0.5 mm</td> </tr> <tr> <td data-bbox="799 913 1214 958">4.0/10.0 – 5</td> <td data-bbox="1219 913 1366 958">7.5 mm</td> <td data-bbox="1370 913 1514 958">1.75 mm</td> </tr> <tr> <td data-bbox="799 958 1214 1003">TUBELESS</td> <td data-bbox="1219 958 1366 1003">4 mm</td> <td data-bbox="1370 958 1514 1003">0.5 mm</td> </tr> <tr> <td data-bbox="799 1003 1214 1048">MADE IN GERMANY</td> <td data-bbox="1219 1003 1366 1048">3 mm</td> <td data-bbox="1370 1003 1514 1048">0.5 mm</td> </tr> <tr> <td data-bbox="799 1048 1214 1093"></td> <td data-bbox="1219 1048 1366 1093"></td> <td data-bbox="1370 1048 1514 1093"></td> </tr> <tr> <td data-bbox="799 1093 1214 1137"></td> <td data-bbox="1219 1093 1366 1137"></td> <td data-bbox="1370 1093 1514 1137"></td> </tr> <tr> <td data-bbox="799 1137 1214 1182"></td> <td data-bbox="1219 1137 1366 1182"></td> <td data-bbox="1370 1137 1514 1182"></td> </tr> <tr> <td data-bbox="799 1182 1214 1227"></td> <td data-bbox="1219 1182 1366 1227"></td> <td data-bbox="1370 1182 1514 1227"></td> </tr> </tbody> </table>	Texte / Text	Hauteur / Height	Trait / Stroke	MOJO (printed)	11 mm	2.5 mm		9 mm		FOR RACING PURPOSE ONLY	4 mm	0.5 mm	MAX. INFLATION PRESSURE 4.0 BAR / 58 PSI	4 mm	0.5 mm	4.0/10.0 – 5	7.5 mm	1.75 mm	TUBELESS	4 mm	0.5 mm	MADE IN GERMANY	3 mm	0.5 mm															
	Texte / Text	Hauteur / Height	Trait / Stroke																																					
	MOJO (printed)	11 mm	2.5 mm																																					
		9 mm																																						
	FOR RACING PURPOSE ONLY	4 mm	0.5 mm																																					
	MAX. INFLATION PRESSURE 4.0 BAR / 58 PSI	4 mm	0.5 mm																																					
	4.0/10.0 – 5	7.5 mm	1.75 mm																																					
	TUBELESS	4 mm	0.5 mm																																					
	MADE IN GERMANY	3 mm	0.5 mm																																					

Photo du flanc intérieur du pneu /
Photo of tyre internal sidewall

Inscription sur le flanc intérieur du pneu /
Inscriptions on tyre internal sidewall

	<table border="1"> <thead> <tr> <th data-bbox="799 1368 1214 1422">Texte / Text</th> <th data-bbox="1219 1368 1366 1422">Hauteur / Height</th> <th data-bbox="1370 1368 1514 1422">Trait / Stroke</th> </tr> </thead> <tbody> <tr> <td data-bbox="799 1422 1214 1467">CIK</td> <td data-bbox="1219 1422 1366 1467">6 mm</td> <td data-bbox="1370 1422 1514 1467">2.0 mm</td> </tr> <tr> <td data-bbox="799 1467 1214 1512">Mini</td> <td data-bbox="1219 1467 1366 1512">5 mm</td> <td data-bbox="1370 1467 1514 1512">0.5 mm</td> </tr> <tr> <td data-bbox="799 1512 1214 1556">MOJO</td> <td data-bbox="1219 1512 1366 1556">18 mm</td> <td data-bbox="1370 1512 1514 1556">5.5 mm</td> </tr> <tr> <td data-bbox="799 1556 1214 1601">4.0/10.0 – 5</td> <td data-bbox="1219 1556 1366 1601">7.5 mm</td> <td data-bbox="1370 1556 1514 1601">1.75 mm</td> </tr> <tr> <td data-bbox="799 1601 1214 1646">TUBELESS</td> <td data-bbox="1219 1601 1366 1646">4 mm</td> <td data-bbox="1370 1601 1514 1646">0.5 mm</td> </tr> <tr> <td data-bbox="799 1646 1214 1691">MADE IN GERMANY</td> <td data-bbox="1219 1646 1366 1691">3 mm</td> <td data-bbox="1370 1646 1514 1691">0.5 mm</td> </tr> <tr> <td data-bbox="799 1691 1214 1736">C2</td> <td data-bbox="1219 1691 1366 1736">5 mm</td> <td data-bbox="1370 1691 1514 1736">0.5 mm</td> </tr> <tr> <td data-bbox="799 1736 1214 1780">CADET</td> <td data-bbox="1219 1736 1366 1780">3.5 mm</td> <td data-bbox="1370 1736 1514 1780">10.5 mm</td> </tr> <tr> <td data-bbox="799 1780 1214 1848">  </td> <td data-bbox="1219 1780 1366 1848">9 mm</td> <td data-bbox="1370 1780 1514 1848"></td> </tr> <tr> <td data-bbox="799 1848 1214 1892"></td> <td data-bbox="1219 1848 1366 1892"></td> <td data-bbox="1370 1848 1514 1892"></td> </tr> <tr> <td data-bbox="799 1892 1214 1937"></td> <td data-bbox="1219 1892 1366 1937"></td> <td data-bbox="1370 1892 1514 1937"></td> </tr> </tbody> </table>	Texte / Text	Hauteur / Height	Trait / Stroke	CIK	6 mm	2.0 mm	Mini	5 mm	0.5 mm	MOJO	18 mm	5.5 mm	4.0/10.0 – 5	7.5 mm	1.75 mm	TUBELESS	4 mm	0.5 mm	MADE IN GERMANY	3 mm	0.5 mm	C2	5 mm	0.5 mm	CADET	3.5 mm	10.5 mm		9 mm										
	Texte / Text	Hauteur / Height	Trait / Stroke																																					
	CIK	6 mm	2.0 mm																																					
	Mini	5 mm	0.5 mm																																					
	MOJO	18 mm	5.5 mm																																					
	4.0/10.0 – 5	7.5 mm	1.75 mm																																					
	TUBELESS	4 mm	0.5 mm																																					
	MADE IN GERMANY	3 mm	0.5 mm																																					
	C2	5 mm	0.5 mm																																					
	CADET	3.5 mm	10.5 mm																																					
		9 mm																																						